

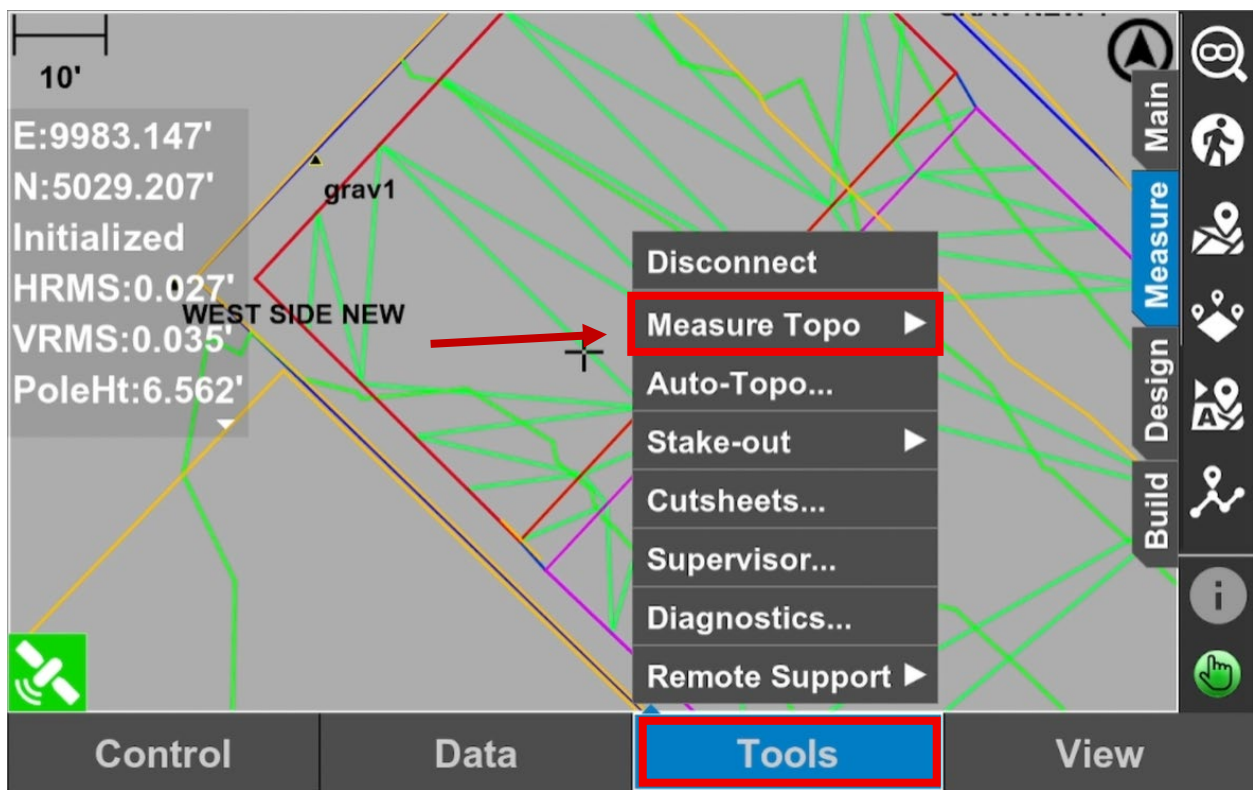

How to Measure in a Topo Shot Topcon V15 Pocket 3D

1. Tap **"Tools"** in the bottom menu then click **"Measure Topo"**.



2. Tap on **"Topo-shot"**.

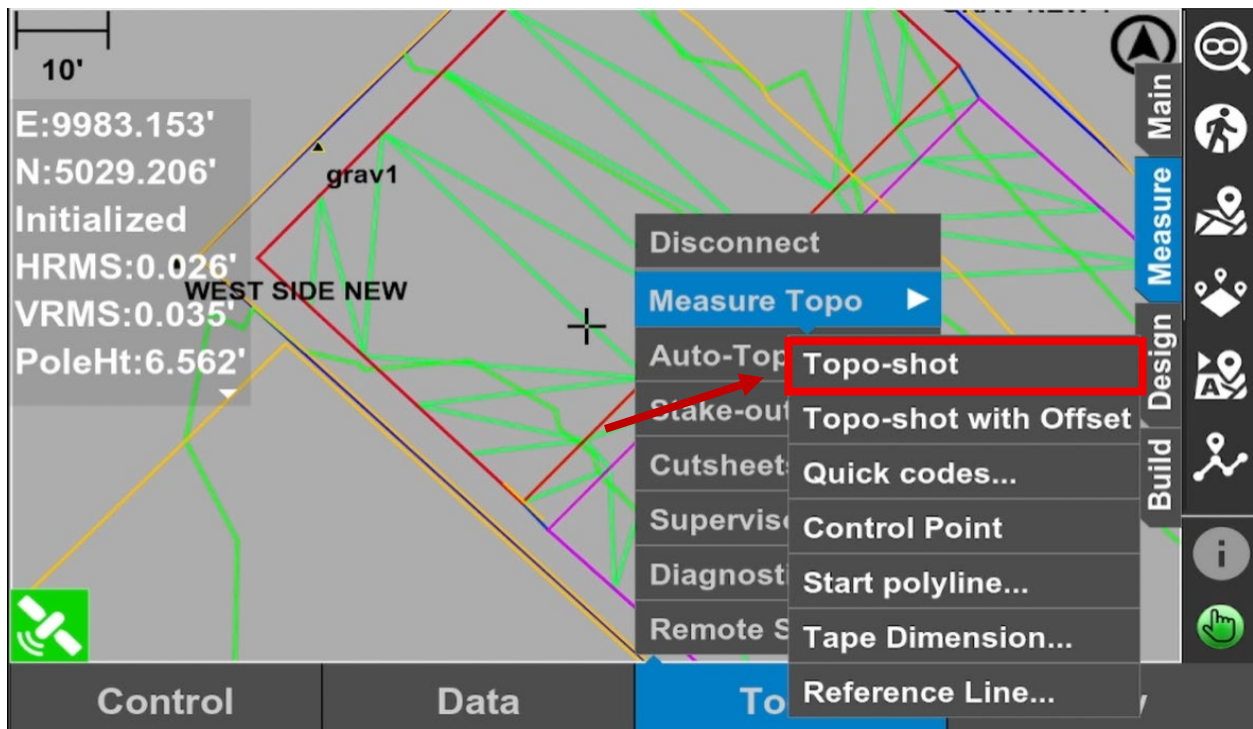

3. Rename your work then click on **"Description"** and **"Add to layer"** (You can add it to a new layer or just choose an existing one.)

Topo-shot ?

Point Options

Name:	WALL0		
Description:	<None>	▼	Adv
Layer:	EX PROPERTY LINE ▼		
Pole Height:	6.562'		
Measure to:	Base ▼		

☒ Show "Topo-shot" Shortcut Button

Measure **Cancel**

4. Leave the “Pole Height” to “6.562”. (Change it if it’s different.) Then the “Measure to” is “Base”.

Topo-shot ⓘ

Point Options

Name: WALL0

Description: <None> Adv

Layer: EX PROPERTY LINE

Pole Height: 6.562'

Measure to: Base

☒ Show "Topo-shot" Shortcut Button

Measure Cancel

5. Tap “Options” then you can adjust the “Sample Count” to 10-15 seconds for more accurate measurement. Tap “Measure”.

Topo-shot ⓘ

Point **Options**

☒ Prompt for details

☒ Before ☐ After

Minimum requirements

Sample Count:	H. Precision:	V. Precision:
2	0.100'	0.200'

☒ Require RTK Initialized

Apply

☒ Show "Topo-shot" Shortcut Button

Measure Cancel

6. Wait for it to finish measuring.

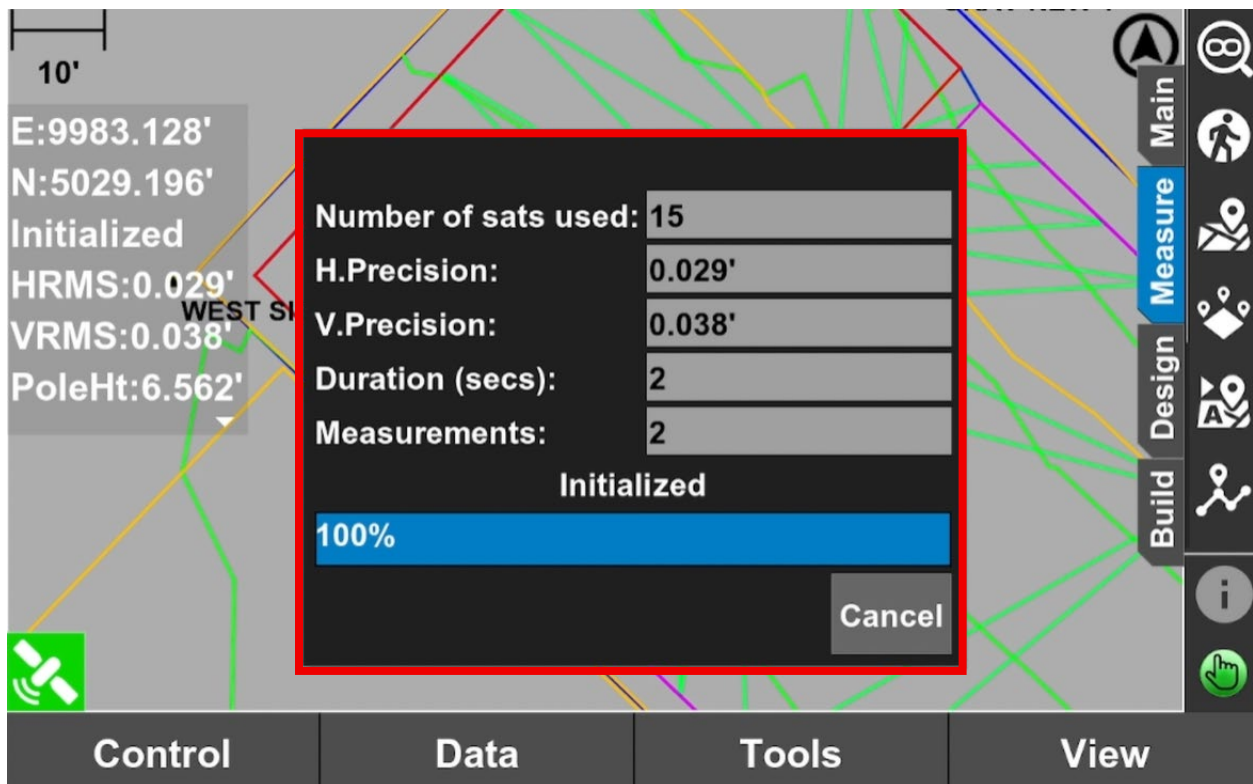

7. You have successfully measured a point.

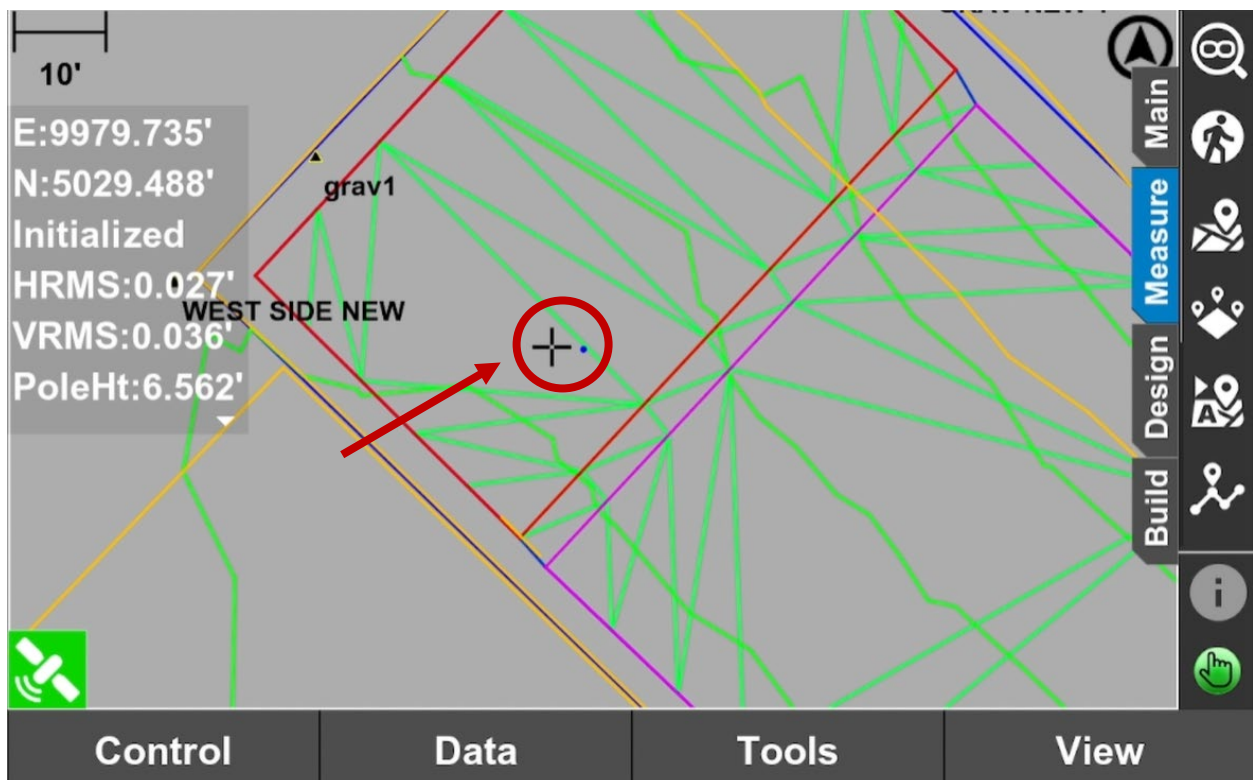

8. Tap **"Measure"** on the top-right corner then tap **"Map with Location"** Icon.

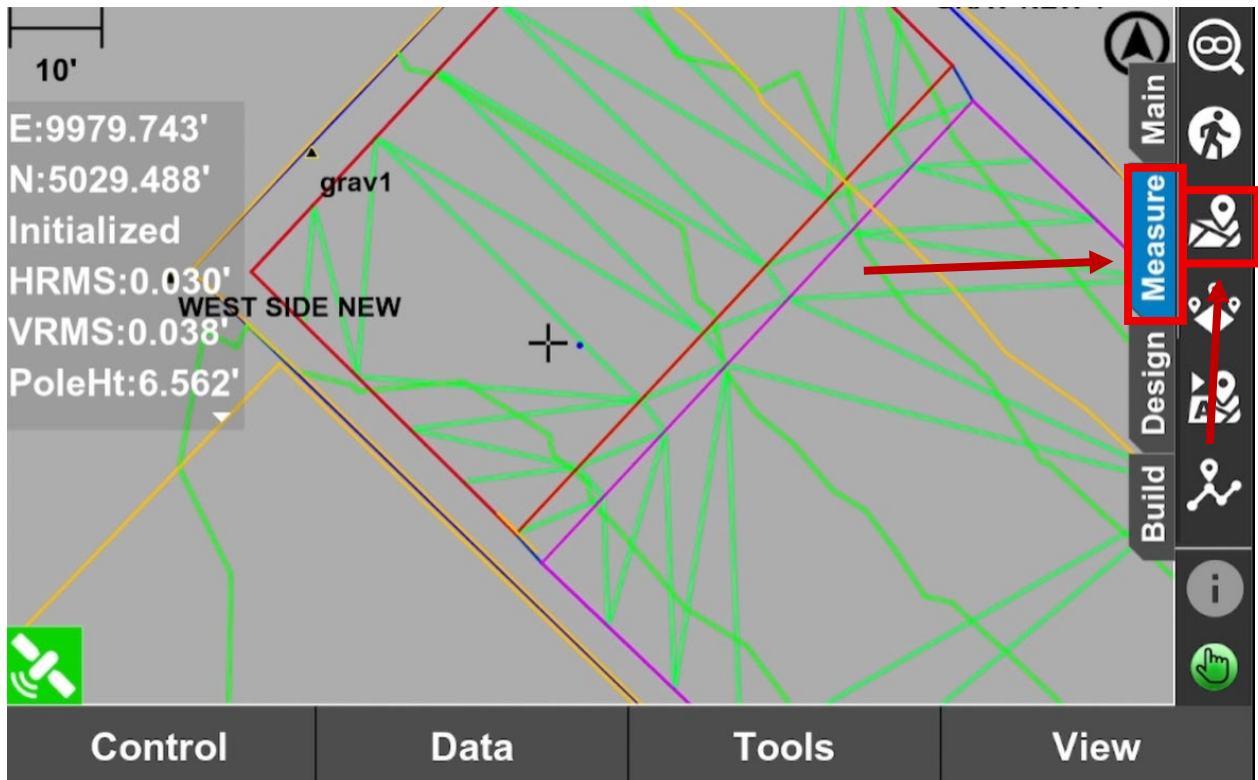

9. Rename your work then click on **"Description"**, **"Add to layer"** and **"Measure"**.

Topo-shot ?

Point Options

Name:	WALL0	
Description:	<None>	Adv
Layer:	EX_PROPERTY_LINE	
Pole Height:	6.562'	
Measure to:	Base	

☒ Show "Topo-shot" Shortcut Button

Measure Cancel

10. Wait for it to finish measuring.

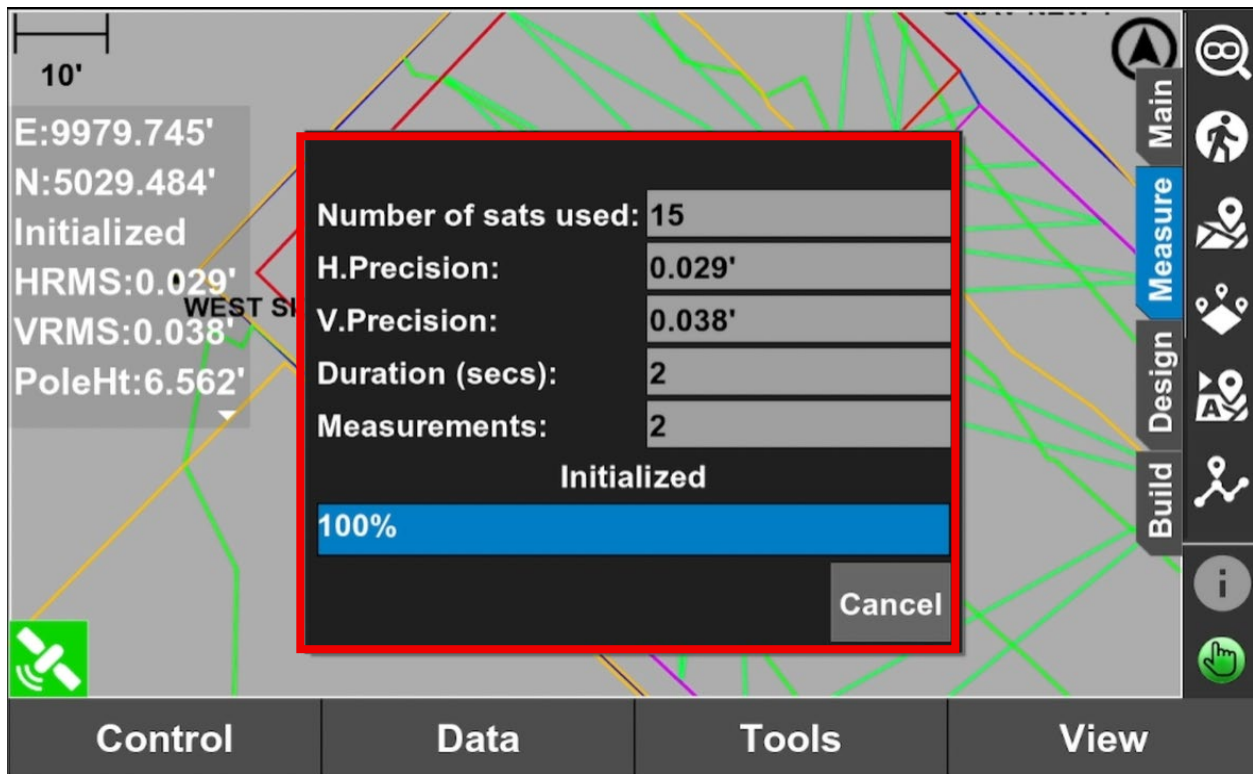

11. You have successfully measured two points.

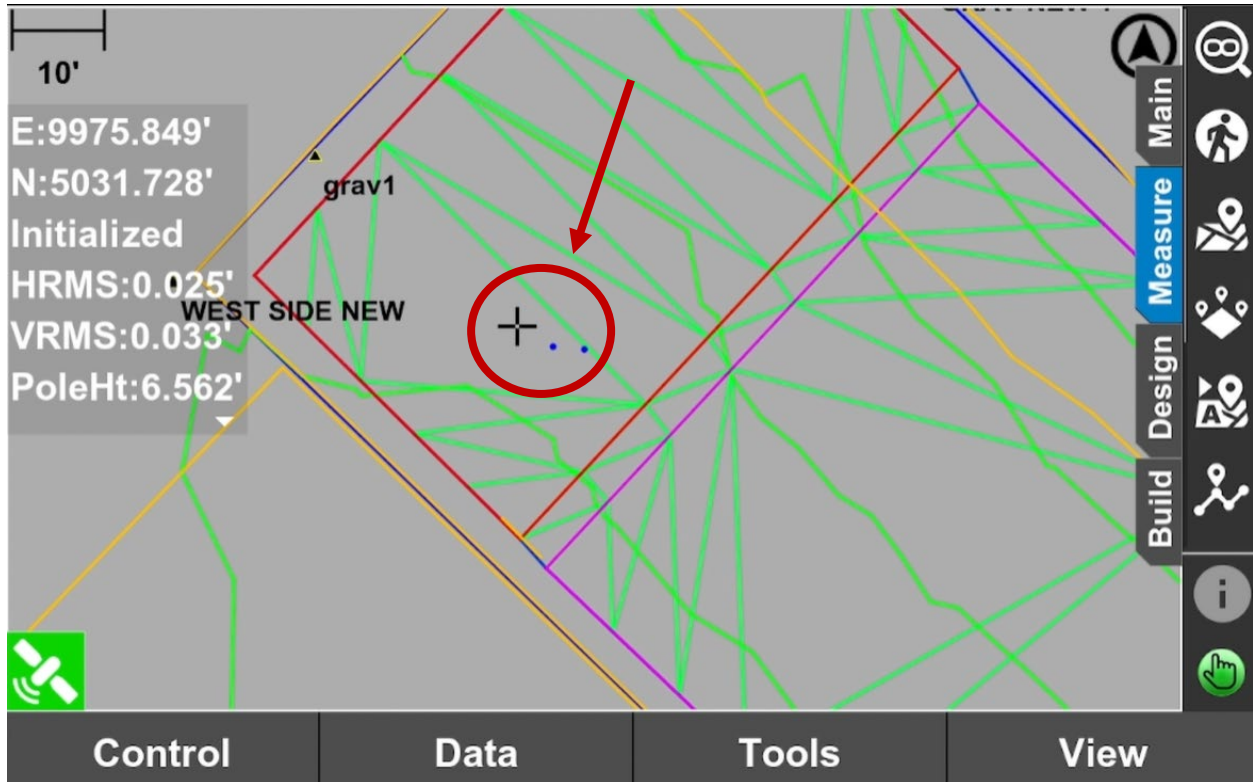

5900 NE 152nd Ave. Suite 120 Vancouver, WA 98682

Phone: (564) 274-0024 | Fax: (360) 635-4924 - Email: Support@4kequipment.com